

LEGEND

EXISTING STONEWALL

ADJUTERS PROPERTY LINES

EXISTING R.O.W. TO REMAIN

PROPOSED R.O.W. LINE

R.O.W. TO BE REMOVED

WETLANDS

DRILL HOLE FOUND

REBAR W/ CAP FOUND

STONE BOUND FOUND

EXISTING POWER POLE

NOTE:
 AN AMENDED EASEMENT SHALL BE RECORDED IN MICRO, AMENDING THE EASEMENT ALONG NORTHERN BOUNDARIES OF LOTS 1 & 10 RECORDED IN MICRO AT BOOK 1900, PAGE 704 ON JANUARY 31, 1980.

APPROVED
 UNDER THE PROVISIONS OF R.S.A. 674:35 & R.S.A. 674:36
CITY PLANNING BOARD
 CITY OF CONCORD, NEW HAMPSHIRE
 IN ACCORDANCE WITH THE VOTE OF THE BOARD DATED:
March 16, 2022
 APPROVAL OF THIS PLAN IS LIMITED TO LOTS AS SHOWN
H. Frank CLERK *9/1/22* *Scott* CHAIRMAN

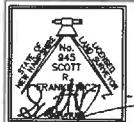

I CERTIFY THAT THIS PLAN IS BASED UPON THE PLAN REFERENCES AND A FIELD SURVEY CONDUCTED ON THE GROUND IN FALL OF 2021, MEETING THE MINIMUM REQUIREMENTS FOR ACCURACY, 1:10,000 AND COMPLETENESS PER THE STATE OF NEW HAMPSHIRE AND THE CITY OF CONCORD, NH.
Scott R. Frankiewicz
 SCOTT R. FRANKIEWICZ, L.L.S. DATE: 9-1-22

EXISTING TAX MAP 203Z, LOT 38
 366,625 SF (8.41 Ac)
 PRIOR TO R.O.W.
 CONVEYANCE TO CITY OF CONCORD
 EXISTING LOT AREA AFTER
 CONVEYANCE OF 8,867 SF TO THE
 CITY OF CONCORD
 357,958 SF (8.22 Ac)

REVISIONS

NO.	DATE	DESCRIPTION	BY
1	07/08/22	REVISED OWNERSHIP, BK. & PAGE	TDB
2	07/08/22	REVISED OWNERSHIP, BK. PG. ALL SHEETS, AND FINAL COMMENTS PER CITY.	TDB

GRAPHIC SCALE
 0 10 20 30 40
 SCALE: 1"=40'

N.H. LAND Consultants
 SURVEYING • LAND PLANNING • REAL ESTATE

 880 S. DIXIE ST. DORCHESTER, VERMONT 05834 PH: 802-442-9220 WEBSTE: NH.LANDCONSULTANTS.COM

RIGHT-OF-WAY, SANITARY SEWER AND STORM DRAINAGE EASEMENT PLAN
 TAX MAP 203Z LOT 39
 145 ABBOTT ROAD, CONCORD, NH 03303
 APPLICANT/OWNER
ABBOTT ROAD, LLC
 14 MADISON LANE, MERRIMACK, NH 03054
 BOOK 3780 PAGE 1211

MERRIMACK CO.
 JOB NO: 510.00
 DATE: JANUARY 19, 2022
ROWP
 SH. 4 of 18